



## VARVAGE

Variable width and length  
straight hardwood flooring

*I don't want to get to the end of my life and find that I lived just the length of it. I want to have lived the width of it as well.*

*Diane Ackerman*

## THERE IS MORE TO LIFE THAN JUST THE LENGTH

There has always existed a difference of opinion between man and nature, with compromises being a rare exception. Until we start growing trees square and straight they will always give us floorboards of variable lengths and widths. We find it unwise to fight against nature.

Using Bole's material saving technologies we are able to find a perfect balance between what people expect their flooring to be like and what nature provides us. We break the traditional, monotonous pattern by making the differences match. The result is absolutely beautiful.







# MATERIALS AND TECHNICAL CHARACTERISTICS

Varvage board is 17 mm (0.67") thick with a 5 mm (0.2") noble timber wear layer and has bevels on all four sides. The boards are connected using the tongue and groove method.

Varvage is produced in mixed widths of 180 mm (7"), 210 mm (8.25") and 240 mm (9.5"). Every order contains about 1/3 of each width per number of rows. The lengths of Varvage are 1000 mm (3.25')–2900 mm (114.17"). About 70% of the order is supplied in lengths longer than 2000 mm (78.7").

## ENGINEERED VARVAGE E17



Core layer: Baltic birch plywood  
 Overall thickness: 17 mm (0.67")  
 Lengths: 1000 mm (3.25')–2900 mm (114.17")  
 Widths: 180 mm (7"), 210 mm (8.25"), 240 mm (9.5")  
 Wear layer thickness: 5 mm (0.2")  
 Core layer thickness: 12 mm (1/2")  
 Overall weight up to: 11.8 kg/m<sup>2</sup> (2.42 lbs/sqft)

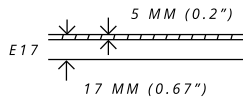

## BEVELS



Varvage is manufactured with 1.1 mm (0.04") bevels on the long edges and 0.7 mm (0.03") on the short edges for natural looks.



## VARVAGE IS AVAILABLE IN



Oak  
 Select, Natural, Rustic



Ash  
 Select, Natural  
 Available by special order

## QUALITY GRADING



Select  
 No sapwood or dark knots. Healthy knots and "cat paw" present.



Natural  
 Sapwood and small dark knots present, as well as healthy knots and "cat paw".



Rustic  
 Sapwood, dark knots and filled cracks up to 2 mm (0.079") in width can be present.

## SPECIAL ORDER

By special order Varvage is also available in Ash. Please contact our sales team for more details and to check availability.







## EMPHASIZE THE EXCEPTIONAL

Celebrating uniqueness and individuality, Bole offers an exclusive variety of hardwood floorings, straight or curved, for commercial buildings or residences, from kitchens to nurseries. Our technology and the experience of our designers allow us to fulfill the vision you have and make any of our floors match to create a feeling of completeness throughout the house. Every final product is an homage to nature, carrying the air of originality, hoping to soothe and to inspire.

The straight, variable length and width Varvage floorboards create possibilities for an endless array of interior design solutions, allowing you to take a turn off the curves without making sacrifices in originality. Combine them with our curved LiveEdge Bole floorboards to fashion an astonishing floor with well-pronounced visual accents.





## REFERENCES

The London boutique of the brilliant designer Paul Smith, exhibiting an inspiringly flawless combination of straight and curved floorboards tailor-made by Bole.







No. 9 Albemarle Street, Mayfair  
Paul Smith store  
United Kingdom

Oak Natural, Natural oil



Private house  
Estonia  
Oak Natural, Godafoss

